

NOTES:  
 Dimensions are in inches  
 Fabricate from .031 Steel  
 Black Enamel after assembling to cover

4/12/13-9/26/14

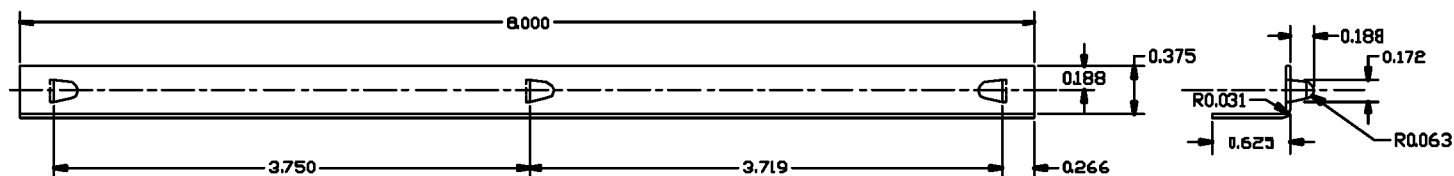

NOTES:  
 Dimensions are in inches  
 Fabricate from .031 Steel  
 Black Enamel after assembling to cover

9/26/14-11/18/14

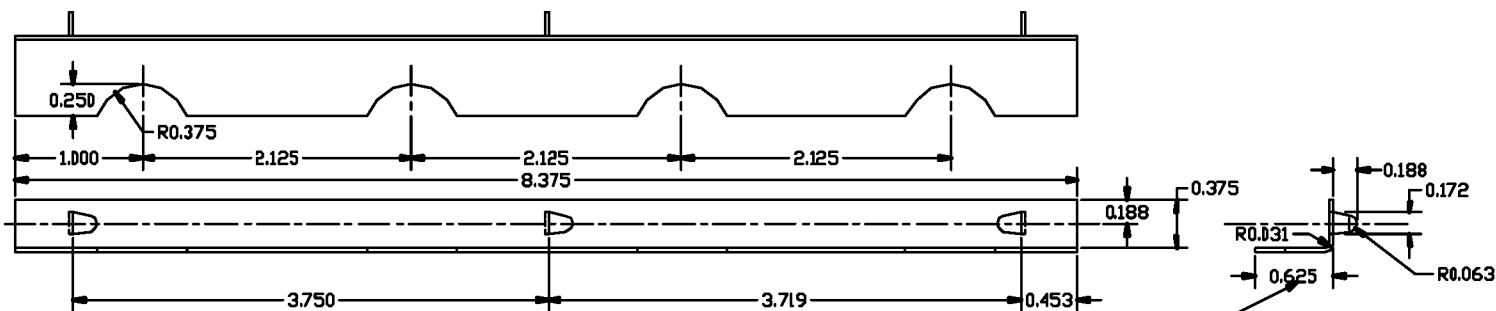

NOTES:  
 Dimensions are in inches  
 Fabricate from .031 Steel  
 Black Enamel after assembling to cover

←.625/.641 beginning 4/7/15

11/18/14-3/11/20

Further changes:

3/11/20 - Ledge which fits on coil unit is bent down at 10 degree angle

5/4/22 - Flange width changes from .625/.641 to .719/.750 and  
 depth of notches from .250 to .344

Remained virtually unchanged from 5/4/22 till end of production

Was not used on '26/'27 car but was used on TT for '26

Title Cover Unit Retainer Strip			
Drawn By JFR	Dir\Filename T5842.dwg	Issue Rev A1	Total Pages 1
Origin Date 4/12/13	Part Number T5842	Revision Date 5/17/01	Page Number 1
Fun Projects, Inc.			
PROPRIETARY- Information presented in this document is the Property of Fun Projects, Inc. and is not to be reproduced or distributed without specific written permission.			