







3 MURPHY FASTENER RINGS IN TOP

FACE MATERIAL TURNED UNDER 2 1/2"

TOP EDGE 1/2" HIGH - INSIDE HEM CUTTING

3 NICKED BRASS RINGS - 3/18 HOLES

NOTE

SCALE - IN ERROR MEASUREMENTS ARE CORRECT

1 MADE 3" MESSURE AT BOTTOM SQUARE WITH FRONT - CHANGED DRAWING

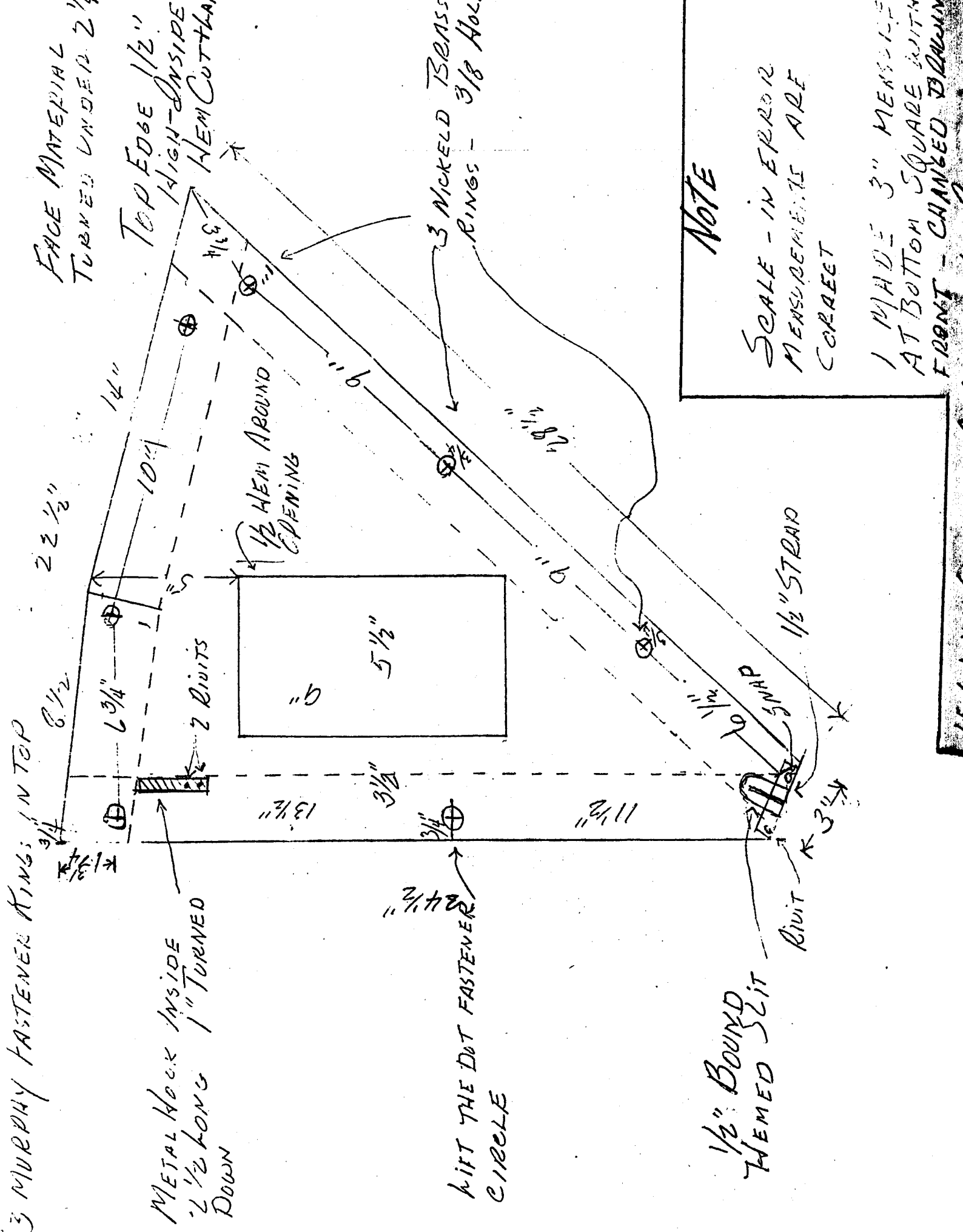

METAL HOOK INSIDE 2 1/2 LONG 1" TURNED DOWN

MARK THE DOT FASTENER CIRCLE

1/2" BOUND HEMED SLIT

RIVET 3/4"

1/2" STRAP

SNAP

